



Rose A. Vallesio
Paralegal

303-858-1800
rvallesio@wbapc.com

December 6, 2024

**VIA ELECTRONIC SUBMISSION
AND ELECTRONIC MAIL**

Division of Local Government

Douglas County Clerk & Recorder
clerk@douglas.co.us

Douglas County Assessor
assessors@douglas.co.us

**Re: Pinery West Metropolitan District No. 2 (LGID#:18112)
Map Filing Pursuant to §32-1-306, C.R.S. – No Change in Boundaries**

To Whom It May Concern:

Section 32-1-306, C.R.S., requires special districts to provide a current, accurate map of their boundaries to the Division of Local Government, County Clerk and Recorder and County Assessor by January 1 of each year. This letter is to inform you that the map that is currently on file with your office for the above-referenced District is the most current and accurate map. A copy of the current map is attached for your convenience.

Should you have any questions, please do not hesitate to contact me.

Sincerely,

WHITE BEAR ANKELE TANAKA & WALDRON
Attorneys at Law

Rose A. Vallesio
Paralegal

Attachment

Boundary Map

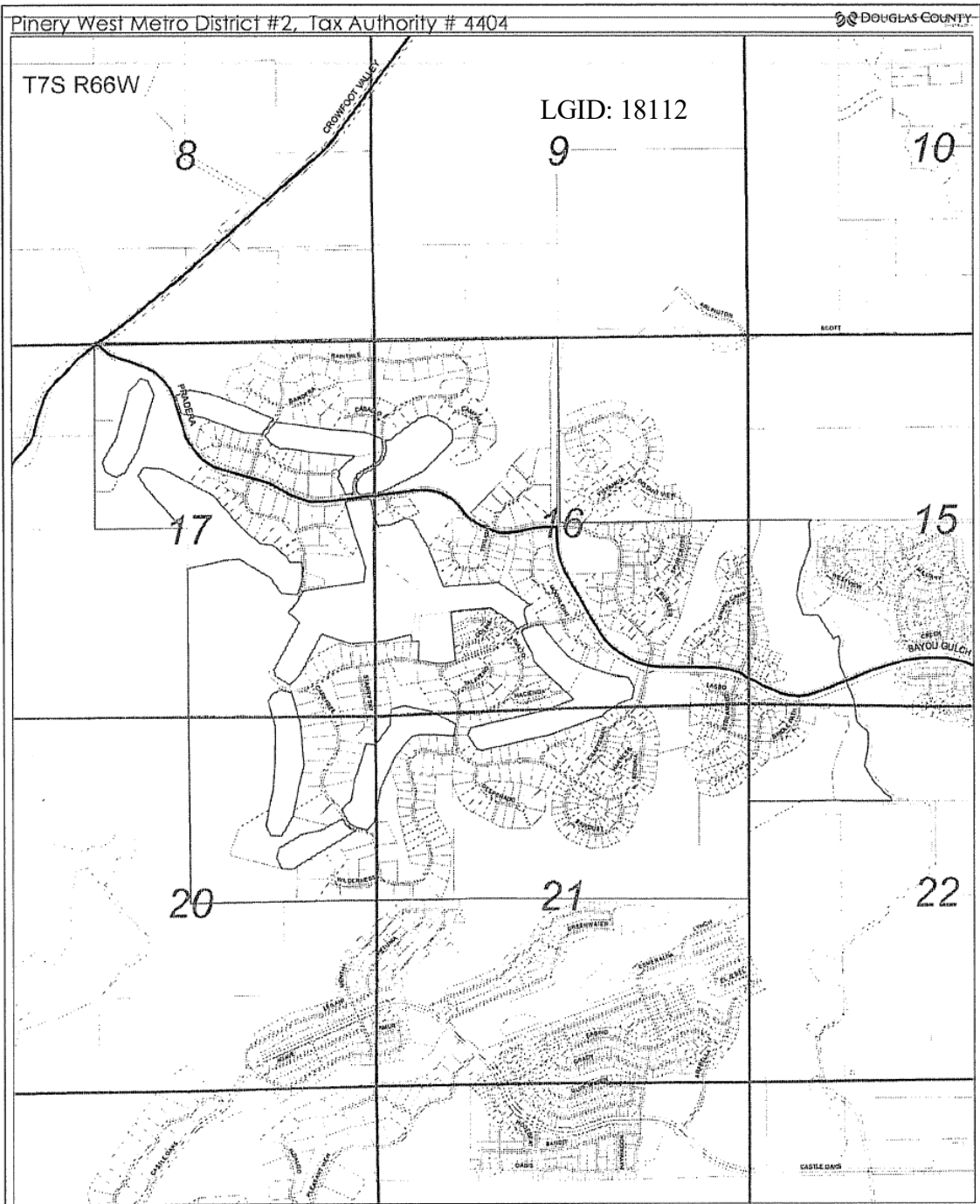

I, Blair Dickhoner, as representative of Pinery West MD No. 2 District, do hereby certify
 Name (printed) District name
 this map to be an accurate representation of the district's boundary as shown. Signed this 21st day of December, 2009.
 Signature: [Signature] Email: bdickhoner@wbapc.com
 Title: Attorney Phone: (303) 858-1800

DISCLAIMER
 All data and information ("Products") contained herein are for informational purposes only. Although such Products are believed to be accurate at the time of printing, Douglas County does not warrant that such Products are error free. Douglas County provides these Products with "as is" and without representation of any kind, express or implied, including, but not limited to, warranties of title and implied warranties of merchantability or fitness for a particular purpose. Douglas County shall be held free of any direct, indirect, incidental, special or consequential damages, including all fees and costs, arising out of the use of such Products, or the inability to use such Products or any part of any branch of any country. The user acknowledges and agrees that the use of such Products is at the user's risk and at the user's expense.

Douglas County does not provide any other Douglas County GIS products, including graphics, animations, cartographic or other products made by Douglas County GIS Division at 1830 48th Street NE, Grand Rapids, MN 55743

Douglas County GIS Division
 Project # 4404-09-001
 Project # 4404-09-001
 Contact: Name: [Name]

Legend

- Pinery West Metro District #2
- Parcels
- Sections
- Townships
- Major Roads
- Local Roads

0.25 0 0.25
 Miles
 1:15,840
 1 inch equals 0.25 miles

Vicinity Map
 Area of Interest

S:\gis\Special\GIS\Map\T_PineryWest_2.mxd - 12/17/2009 4:46:17 PM